

CHASERVO

HV06 / HV06H / HV06N
Technische Daten / Technical Data

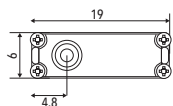

HV06 15T 6mm HV Servo



HV06N

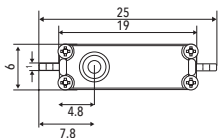
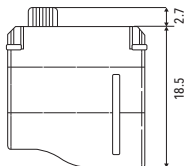

HV06H

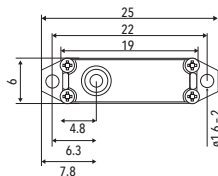
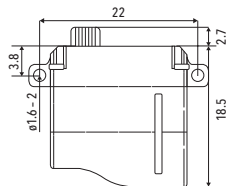

HV06

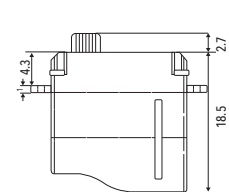

Maße in mm / Dimensions in mm

Performance

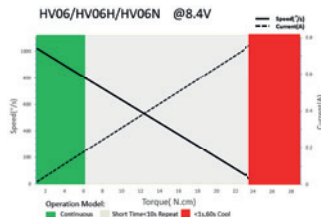

Chaservo

Ob Wettbewerb, Training oder Zeitvertreib – auf die Komponenten muss jederzeit Verlass sein. **CHASERVO** liefert weltmeisterliche Performance und höchste Verarbeitungsstandards zu Budgetfreundlichen konditionen. Damit dem nächsten Triumph nichts mehr im Wege steht.

Whether competition, training or pastime - the components must be reliable at all times. **CHASERVO** delivers world-class performance and the highest standards of workmanship at budget-friendly conditions. So that nothing stands in the way of the next triumph.

Servo Data

Rated Voltage	DC 8.4V
Voltage Range	DC 6V - 8.4V
Stalling Torque	15N.cm@6.0V
	20N.cm@7.4V
	24N.cm@8.4V
No-load Speed	0.07sec/60°@6.0V
	0.06sec/60°@7.4V
	0.05sec/60°@8.4V
Default Travel Angle	$\pm 60^\circ = 120^\circ$ Total travel
Working Frequency	1520us/20KHz
Operating Temperature Range	-10°C ... +65°C
Case Material	Aluminum Alloy
Motor Type	Coreless DC Motor
Gear Set Material	Hardened Steel
Position Sensor	Potentiometer
Programmable	YES

CHASERVO

Ball Bearing	2BB
Case Dimensions	19mm*6mm*18.5mm ± 0.2 mm
Weight	5.8g $\pm 10\%$

Command Signal / PWM Interface

Signal voltage level	HIGH:min.3.3V,max.5.0V Low:min.0.0V,max.1.5V
Pulse range	900us-2100us
Pulse Corresponding Angle	1000us/1500us/2000us

Electrical Connection

<p>3 2 1</p>	1	Orange	PWM	PWM Command Signal
	2	Red	DC+	Supply Voltage
	3	Brown	DC-	Supply Ground, Signal Ground

www.chaservo.de

CHASERVO

Championship Performance

AKATJA GmbH

Burgwaldring 13

86697 Oberhausen-Kreut



www.chaservo.de